

The 18kW power shelf is a 12-slot chassis with dual input sources, N+N redundancy, that can be configured to accept either single phase or three phase input. Output is ground-isolated 50Vdc, 360A with floating power clip to allow quick connection to rack bus bar. Power Supply Unit is 3kW rectifier capable of hot-insertion, active current sharing, PMBus communication over I2C.

Key Features

- Dual AC inputs: single phase or three phase input cable option
- 12PSUs in N+N configuration
- DC output is ground-isolated for flexible grounding at rack level
- High efficiency 3kW PSU
- 2OU, 21-inch width power shelf
- Floating output DC power clip for quick connection to rack bus bar
- Shelf Management Controller provides system communication capability for shelf remote control along with power monitoring. (Shelf Management Controller is not required for basic Power Shelf operation)



Specifications

Electrical	
Maximum Output Power	18kW
Input	208/240/277Vac
Output	50Vdc/360A
Frequency	50Hz – 60Hz
Communications	PMBUS 1.2
EMI	EN55022, CISPR 22: Conducted Emission, Class A EN55022, CISPR 22: Radiated Emission, Class A
Physical	
Dimensions (H x W x D)	3.45" x 21.14" x 25.73" (87.6 mm x 537 mm x 653.5 mm)
Weight	51 lbs (23.1 kg) without PSUs
Form Factor	2OU, 21" Rack Mount
Environment	
Temperature	Operating: 0°C – +45°C, Storage: -40°C – +70°C
Humidity	10% – 90% relative (non-condensing)
Altitude	Operating: 0 – 10,000ft
Acoustic	90.5dB at 1 m
General	
Approvals	UL60950-1, IEC60950-1 International, GB4943, RoHS
Mounting Hardware	2 mounting brackets and 12 screws (included)
Warranty	3 Years

Mechanical

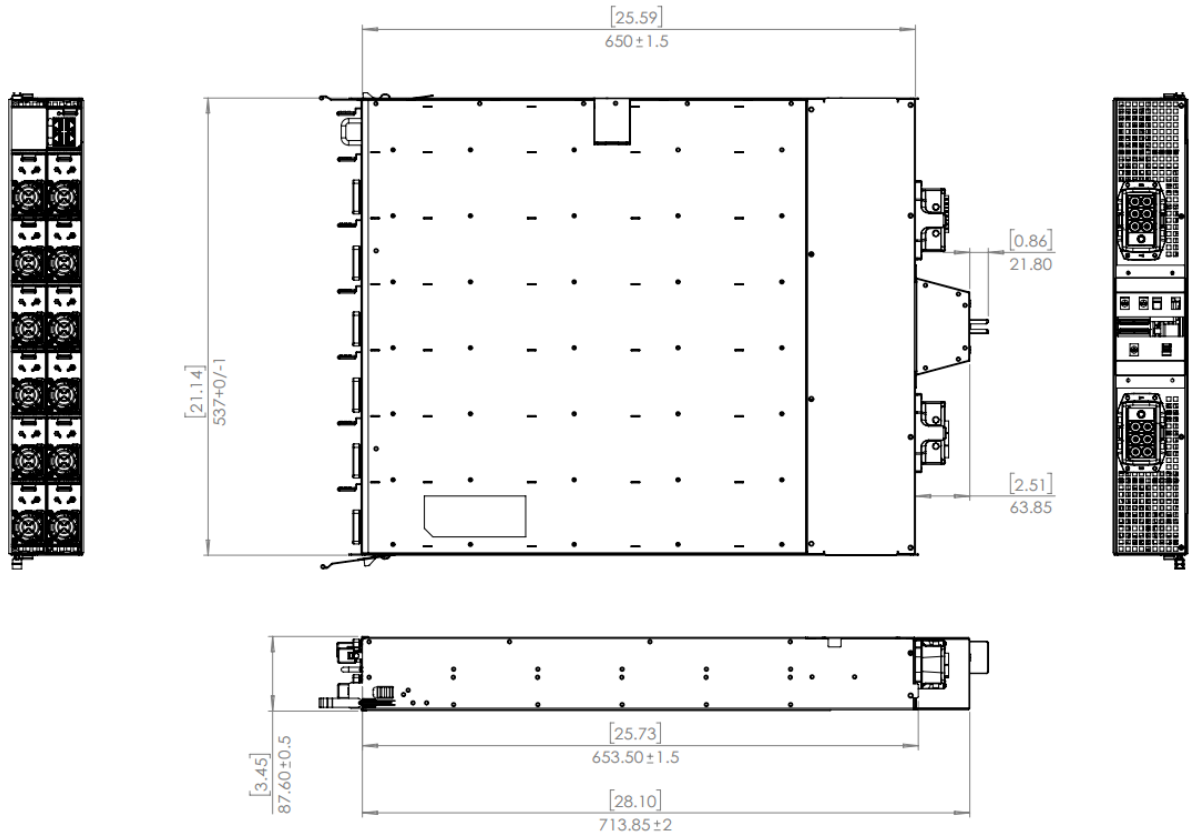

Front Panel

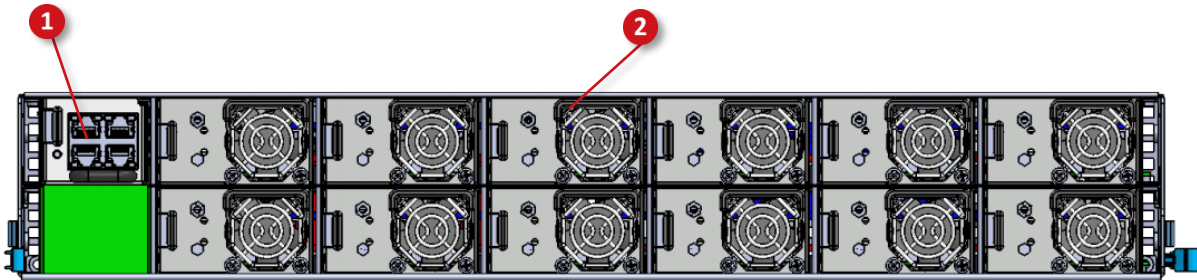

1	Shelf Management Controller Port	Optional Shelf Management Controller to enable communication between PSUs and Data Center Manager
2	Power Supply Units	Single phase 208V to 277V Input, 50Vdc/60A